

## AMERICAN FLANGES

**22A**  
CHOKE + SEALING GROOVE

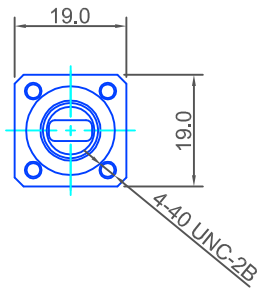

UG-600A/U  
MIL-F-3922/59-005

**22B**  
COVER / PLAIN

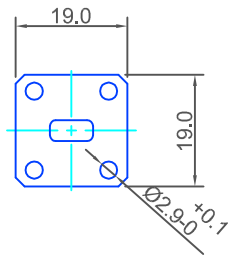

UG-599 /U  
(MIL-F-3922/54-003)

**22Y**  
SEALING GROOVE

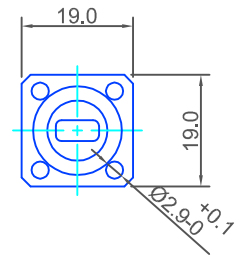

UG-599 /U *Modified*  
MIL-F-3922/54-003 *Modified*

## EUROPEAN FLANGES

**22G**  
CHOKE + SEALING GROOVE

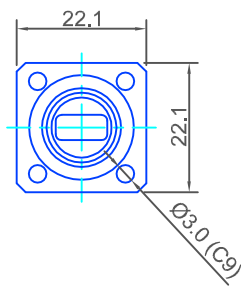

154 IEC-CBR 320

**22K**  
SEALING GROOVE

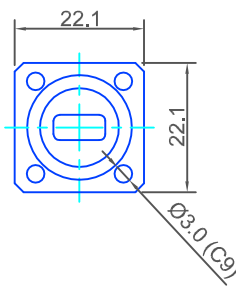

154 IEC-PBR 320

**22M**  
COVER / PLAIN

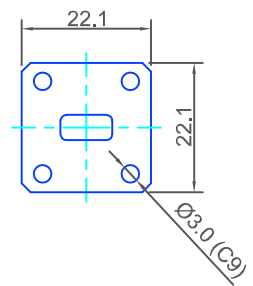

154 IEC-UBR 320